

621 Skygrove Dr, Holly Springs NC 27540

FIRST FLOOR

SECOND FLOOR

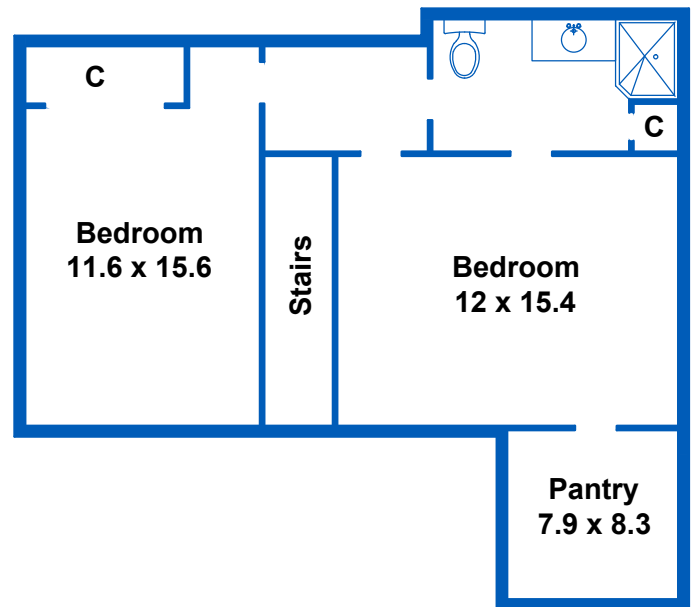
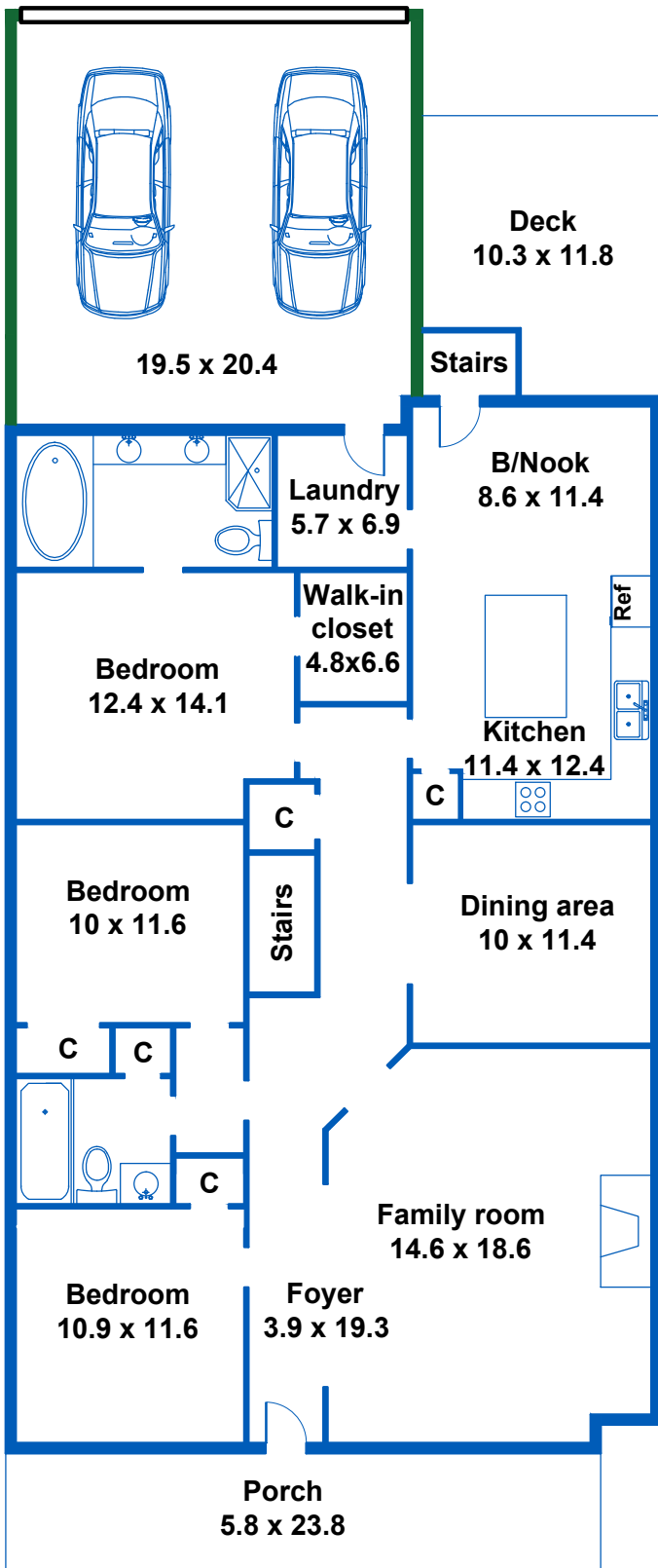

"Approximate dimensions"
"Drawing not to exact scale"
"This measurement is copyrighted to McNamara & Co and the clients listed on the header of this sketch"

AREA CALCULATIONS SUMMARY

Code	Description	Gross	Total
GLA 1	First Floor	1606.2	1606.2
GLA 2	Second Floor	682.9	682.9
GAR	Garage	407.3	407.3