

**SKETCH ADDENDUM**

Borrower or Owner  
 Property Address 10112 Bessborough Drive  
 City Raleigh County Durham State NC Zip Code 27617  
 Client eXp - Tammie Harris Group

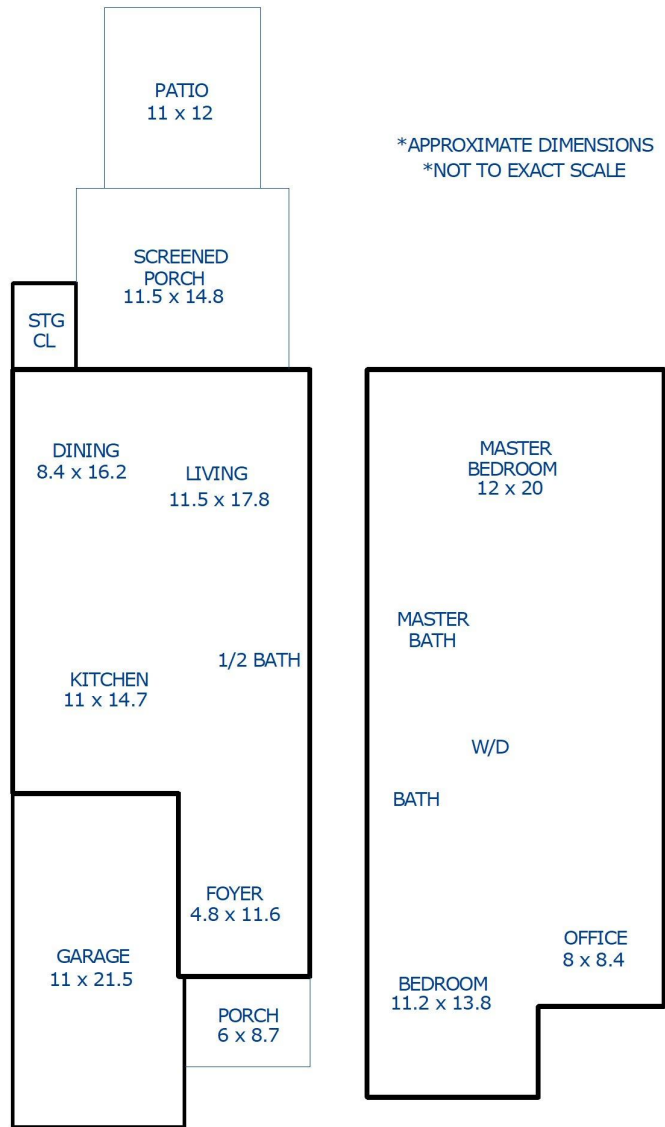

Sketch by Apex Sketch v5 Standard™

Comments: **\*\*This measurement is copyrighted to McNamara & Co and the clients listed in the header of this sketch.\*\***  
**\*\*No one else may use.\*\***

AREA CALCULATIONS SUMMARY			
Code	Description	Net Size	Net Totals
GLA1	First Floor	702.63	702.63
GLA2	Second Floor	958.80	958.80
GAR	Garage	262.57	262.57
OTH	Storage	25.65	25.65
Net LIVABLE Area		(rounded)	1661

LIVING AREA BREAKDOWN		
	Breakdown	Subtotals
First Floor		
	21.0 x 28.1	590.10
	12.1 x 9.3	112.53
Second Floor		
	21.0 x 42.2	886.20
	6.0 x 12.1	72.60
4 Items	(rounded)	1661