

### Subject Photo Page

|                  |               |        |         |       |                   |
|------------------|---------------|--------|---------|-------|-------------------|
| Client           | Lender/Client |        |         |       |                   |
| Property Address | 1402 Trio Dr  |        |         |       |                   |
| City             | Siler City    | County | Chatham | State | NC Zip Code 27344 |
| Lender/Client    | Lender/Client |        |         |       |                   |



#### Subject Front

1402 Trio Dr  
Sales Price 129,000  
Gross Living Area 1,523  
Total Rooms 6  
Total Bedrooms 3  
Total Bathrooms 2.0  
Location N;Res;Res  
View N;Res;Res  
Site 9583 sf  
Quality Q4  
Age 12



#### Subject Rear

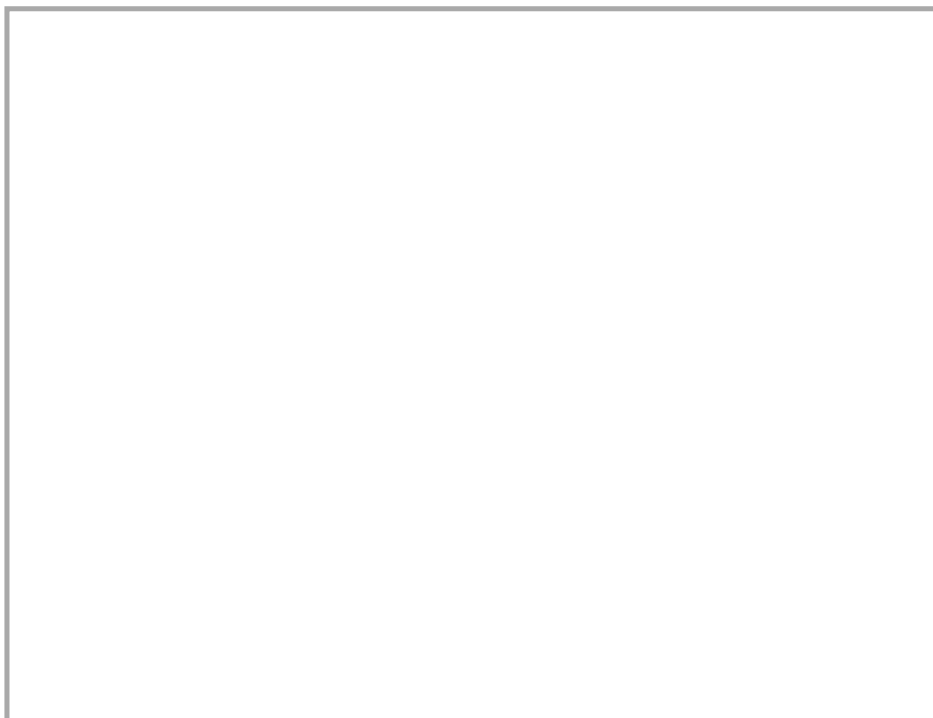

#### Subject Street

### Subject Photo Page

|                  |               |        |         |       |                   |
|------------------|---------------|--------|---------|-------|-------------------|
| Client           | Lender/Client |        |         |       |                   |
| Property Address | 1402 Trio Dr  |        |         |       |                   |
| City             | Siler City    | County | Chatham | State | NC Zip Code 27344 |
| Lender/Client    | Lender/Client |        |         |       |                   |

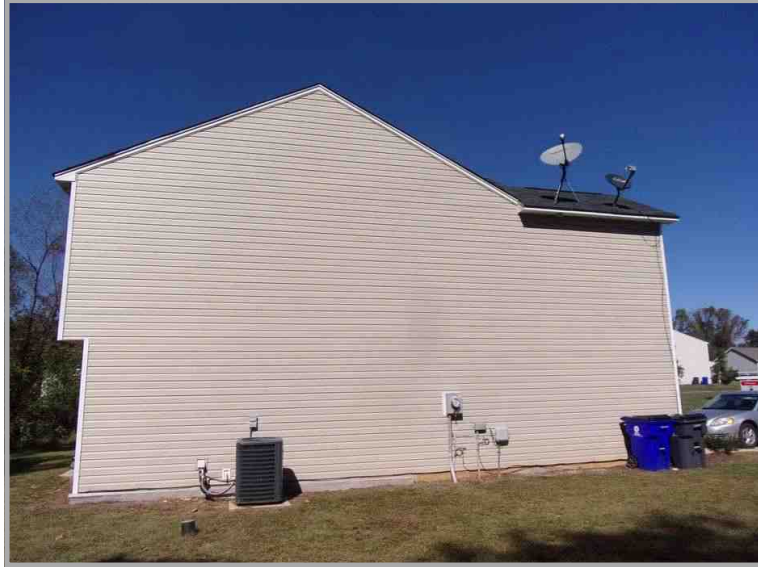

#### Subject Side View

1402 Trio Dr  
Sales Price 129,000  
Gross Living Area 1,523  
Total Rooms 6  
Total Bedrooms 3  
Total Bathrooms 2.0  
Location N;Res;Res  
View N;Res;Res  
Site 9583 sf  
Quality Q4  
Age 12



#### Subject Side View

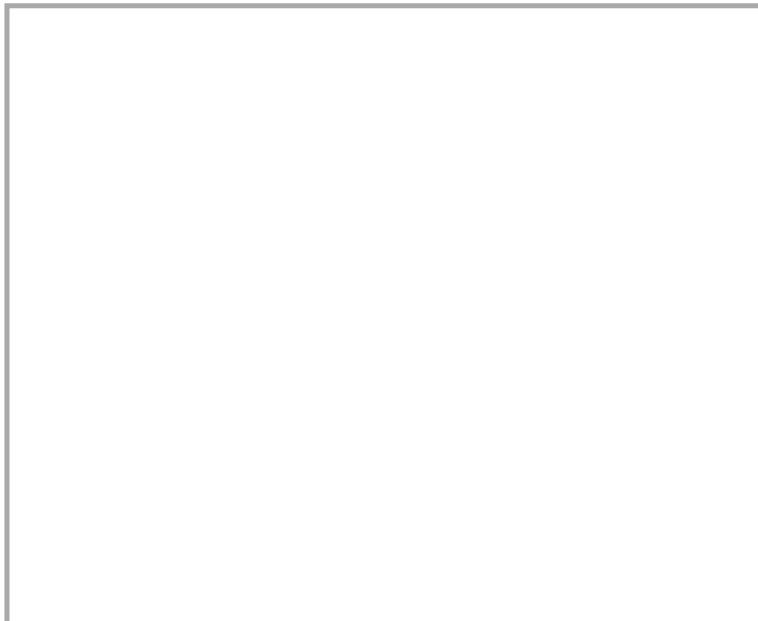

### Building Sketch

|                  |               |                |                         |
|------------------|---------------|----------------|-------------------------|
| Client           | Lender/Client |                |                         |
| Property Address | 1402 Trio Dr  |                |                         |
| City             | Siler City    | County Chatham | State NC Zip Code 27344 |
| Lender/Client    | Lender/Client |                |                         |

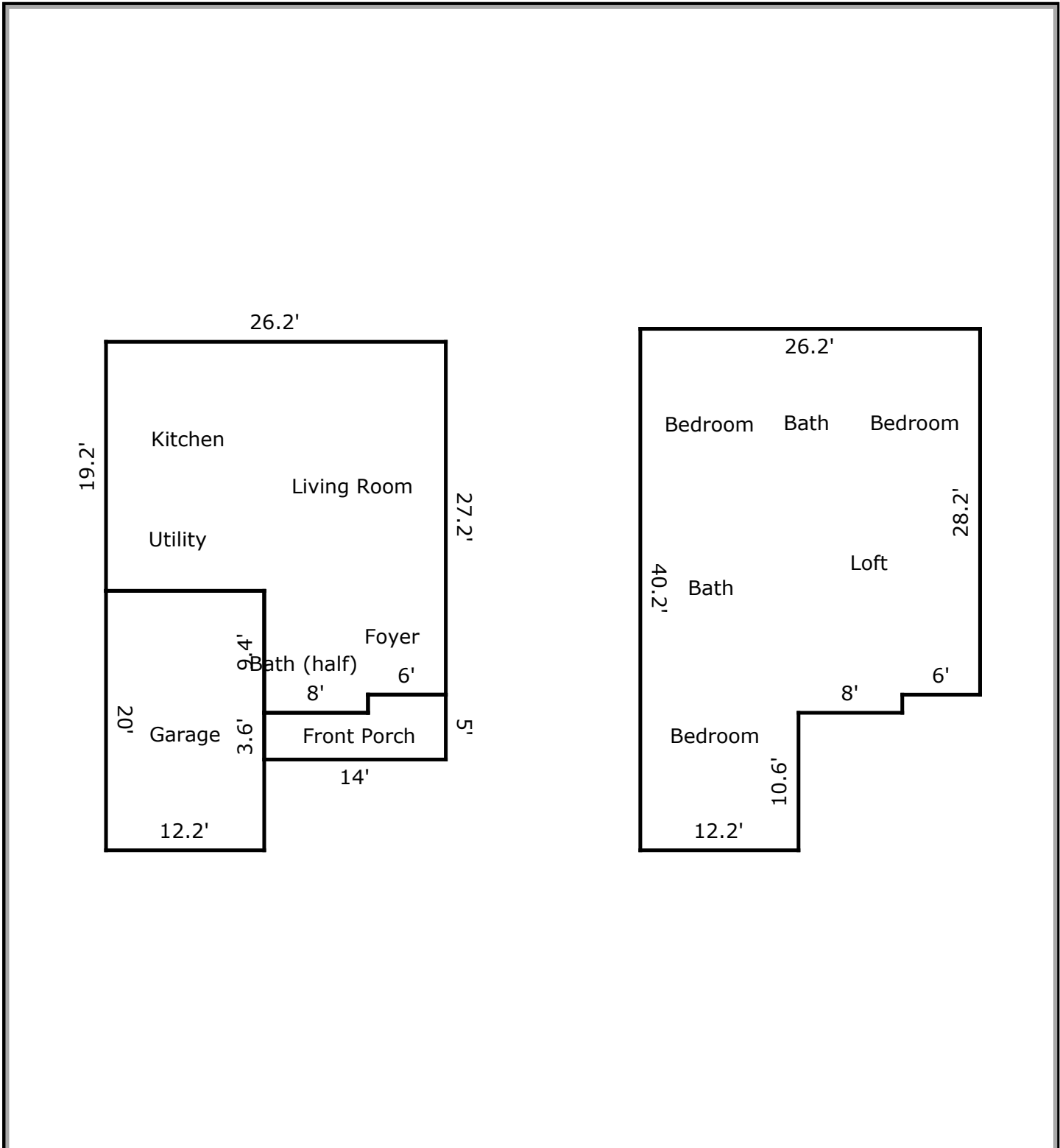

TOTAL Sketch by a la mode, inc.

#### Area Calculations Summary

| Living Area                         | Calculation Details |  |
|-------------------------------------|---------------------|--|
| First Floor                         | 626.24 Sq ft        | $26.2 \times 19.2 = 503.04$<br>$9.4 \times 8 = 75.2$<br>$6 \times 8 = 48$        |
| Second Floor                        | 896.44 Sq ft        | $26.2 \times 28.2 = 738.84$<br>$12 \times 12.2 = 146.4$<br>$8 \times 1.4 = 11.2$ |
| <b>Total Living Area (Rounded):</b> | <b>1523 Sq ft</b>   |  |
| <b>Non-living Area</b>              |                     |  |
| 1 Car Attached                      | 244 Sq ft           | $12.2 \times 20 = 244$   |
| Open Porch                          | 58.8 Sq ft          | $5 \times 6 = 30$<br>$8 \times 3.6 = 28.8$                                       |