

Building Sketch (Page - 1)

Borrower	N/A						
Property Address	1407 Chelton Oaks Pl						
City	Raleigh	County	Wake	State	NC	Zip Code	27614
Lender/Client	N/A						

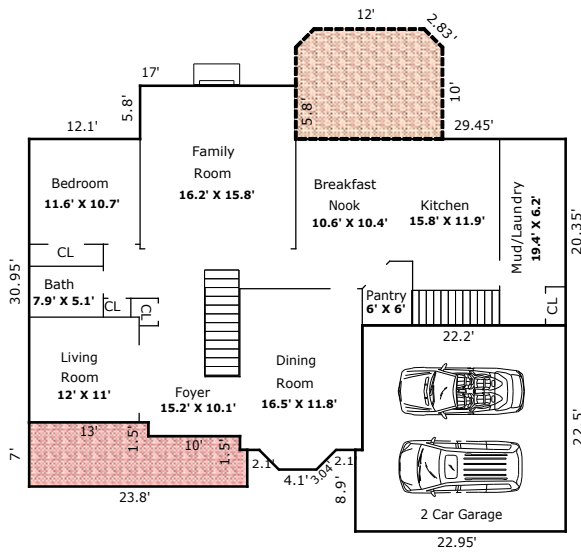

*****Lofted Storage in Garage approx.
18.5' X 8.8' or 162.8 SF*****

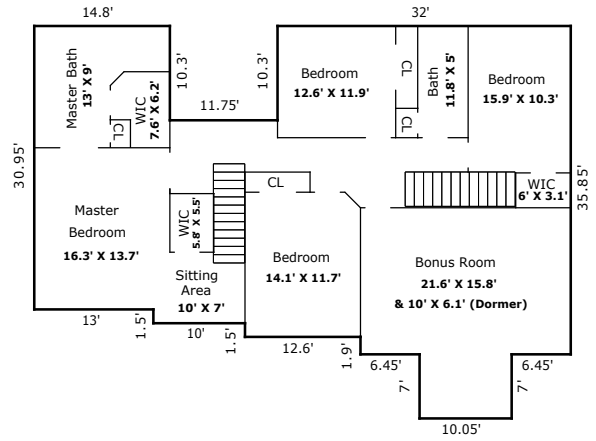

Building Sketch (Page - 2)

Borrower	N/A						
Property Address	1407 Chelton Oaks Pl						
City	Raleigh	County	Wake	State	NC	Zip Code	27614
Lender/Client	N/A						

TOTAL Sketch by a la mode, inc.

Area Calculations Summary

Living Area	Calculation Details		
First Floor	1743.89 Sq ft		
		$0.5 \times 2.15 \times 2.15 =$	2.31
		$0.5 \times 2.15 \times 2.15 =$	2.31
		$4.1 \times 2.15 =$	8.82
		$17 \times 5.8 =$	98.6
		$20.35 \times 22.2 =$	451.77
		$36.35 \times 30.95 =$	1125.03
		$3 \times 13.35 =$	40.05
		$10 \times 1.5 =$	15
Second Floor	1926.7 Sq ft		
		$10.05 \times 7 =$	70.35
		$14.8 \times 10.3 =$	152.44
		$35.85 \times 22.95 =$	822.76
		$9.05 \times 10.3 =$	93.22
		$20.65 \times 13 =$	268.45
		$22.6 \times 22.15 =$	500.59
		$1.5 \times 12.6 =$	18.9
Total Living Area (Rounded):	3671 Sq ft		
Non-living Area			
2 Car Attached	506.17 Sq ft		
		$22.5 \times 22.2 =$	499.5
		$0.75 \times 8.9 =$	6.68
Covered Porch	149.2 Sq ft		
		$7 \times 13 =$	91
		$5.5 \times 10 =$	55
		$0.8 \times 4 =$	3.2
Wood Deck	188 Sq ft		
		$16 \times 10 =$	160
		$12 \times 2 =$	24
		$0.5 \times 2 \times 2 =$	2
		$0.5 \times 2 \times 2 =$	2