

Building Sketch (Page - 1)

Borrower	N/A			
Property Address	212 Preston Pines Dr			
City	Cary	County Wake	State NC	Zip Code 27513
Lender/Client	N/A			

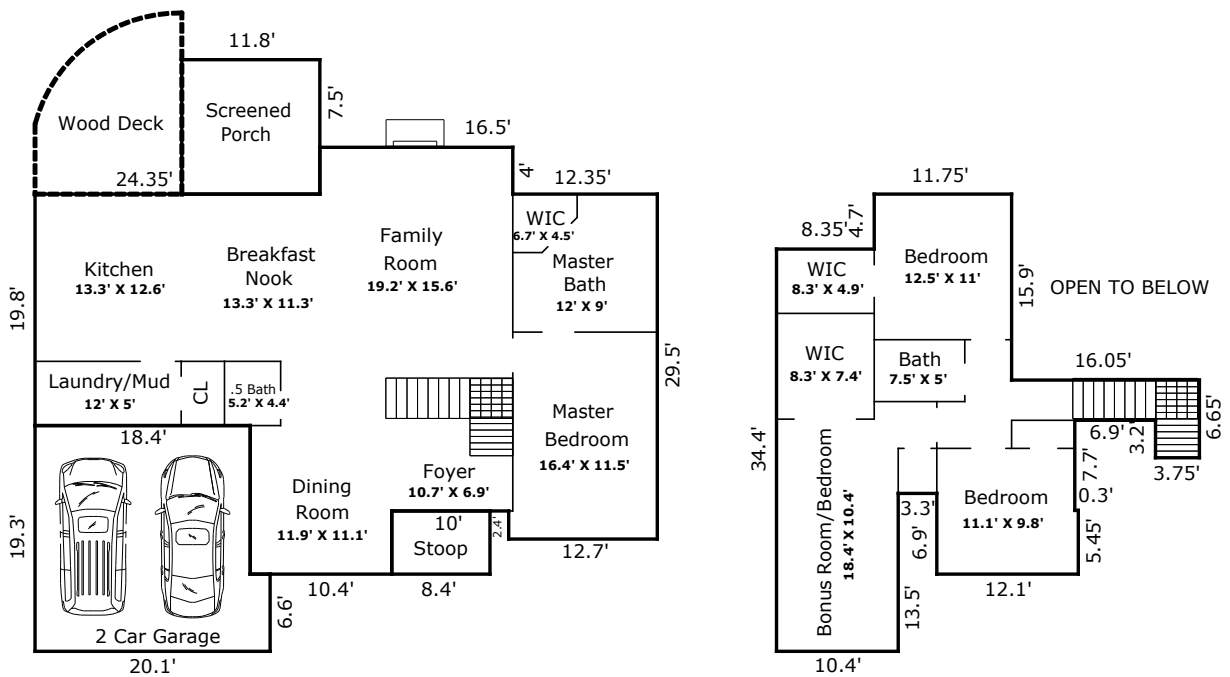

TOTAL Sketch by a la mode, inc.

Building Sketch (Page - 2)

Borrower	N/A			
Property Address	212 Preston Pines Dr			
City	Cary	County Wake	State NC	Zip Code 27513
Lender/Client	N/A			

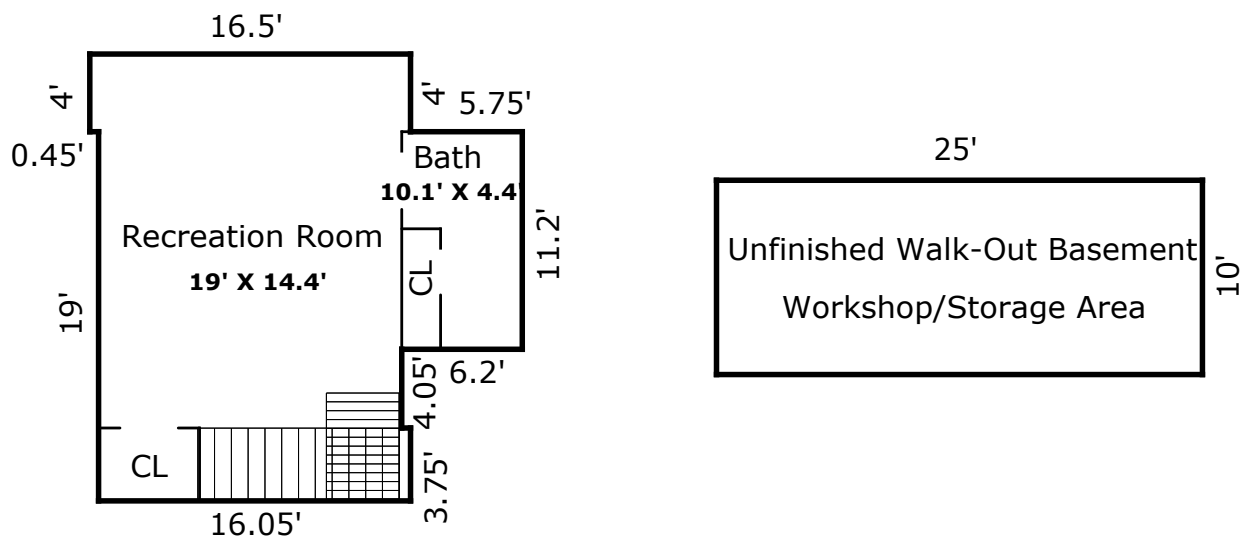

TOTAL Sketch by a la mode, inc.

Building Sketch (Page - 3)

Borrower	N/A			
Property Address	212 Preston Pines Dr			
City	Cary	County Wake	State NC	Zip Code 27513
Lender/Client	N/A			

TOTAL Sketch by a la mode, inc.

Area Calculations Summary

Living Area	Calculation Details		
First Floor	1469.22 Sq ft	16.5×4	= 66
		19.8×18.4	= 364.32
		34.8×27.1	= 943.08
		2.4×12.7	= 30.48
		12.1×5.4	= 65.34
Second Floor	799.89 Sq ft	10.4×13.5	= 140.4
		6.65×3.75	= 24.94
		3.45×6.9	= 23.8
		12.1×5.45	= 65.94
		11.15×5.4	= 60.21
		11.75×4.7	= 55.22
		20.1×20.9	= 420.09
		6.4×1.45	= 9.28
Total Living Area (Rounded):	2269 Sq ft		
Non-living Area			
Stoop	45.36 Sq ft	8.4×5.4	= 45.36
2 Car Attached	366.34 Sq ft	19.3×18.4	= 355.12
		1.7×6.6	= 11.22
Screened Porch	135.7 Sq ft	11.8×11.5	= 135.7
Wood Deck	163.9 Sq ft	12.55×6	= 75.3
		$0.5 \times 12.55 \times 9.5$	= 59.61
		Arc	= 28.99
Finished Basement	433.53 Sq ft	16.5×4	= 66
		19×15.6	= 296.4
		11.2×6.2	= 69.44
		3.75×0.45	= 1.69
Unfinished Basement	250 Sq ft	10×25	= 250