

Building Sketch (Page - 1)

Borrower	N/A			
Property Address	7942 Lancaster Store Rd			
City	Castalia	County	Wake	State NC Zip Code 27816
Lender/Client	N/A			

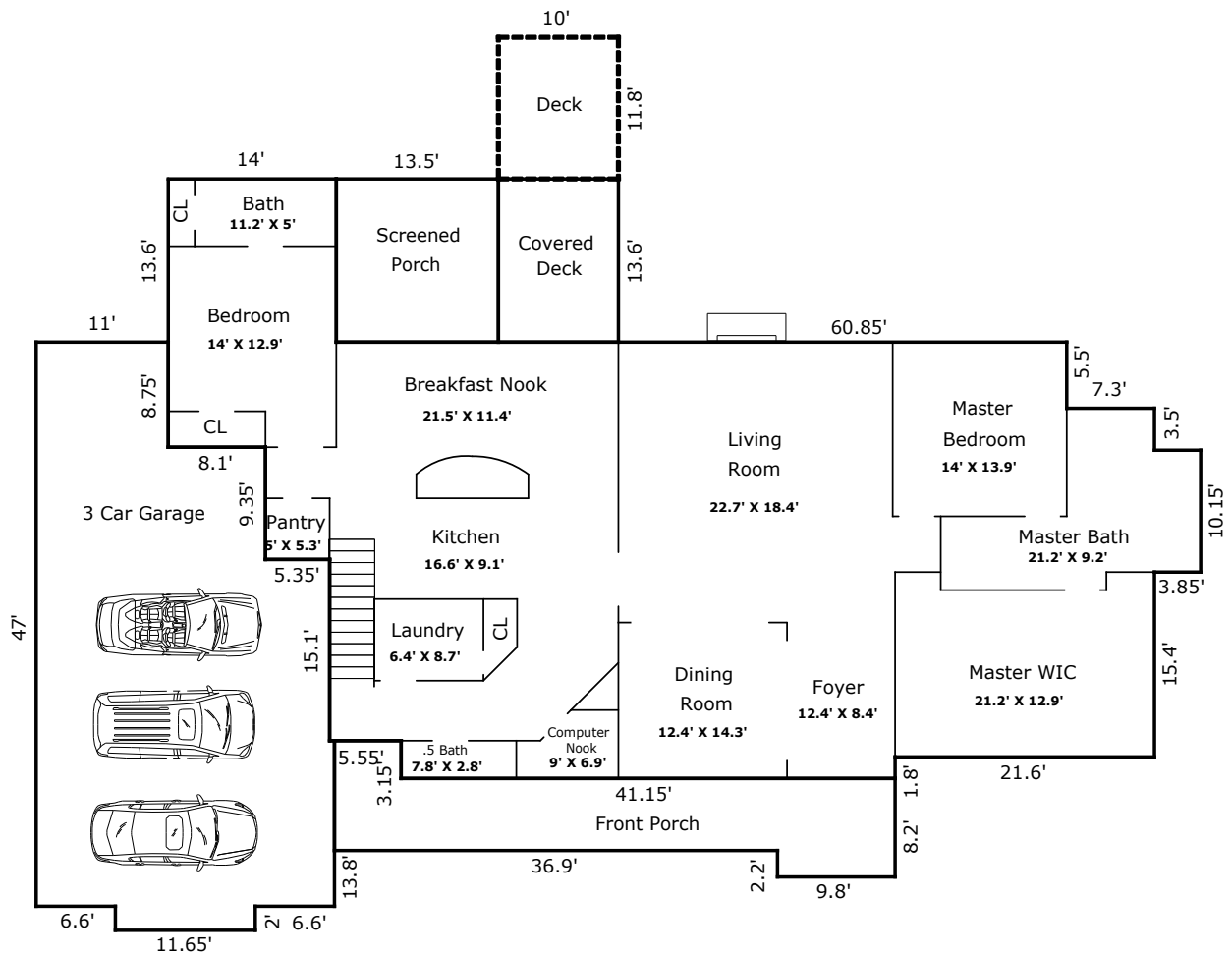

TOTAL Sketch by a la mode, inc.

Building Sketch (Page - 2)

Borrower	N/A			
Property Address	7942 Lancaster Store Rd			
City	Castalia	County	Wake	State NC Zip Code 27816
Lender/Client	N/A			

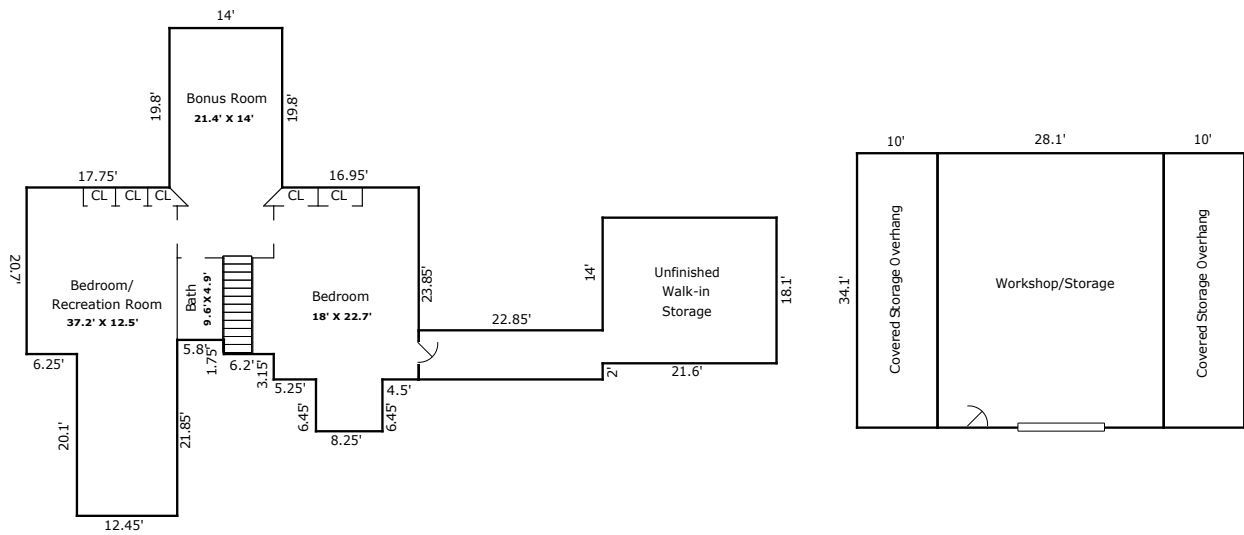

TOTAL Sketch by a la mode, inc.

Building Sketch (Page - 3)

Borrower	N/A			
Property Address	7942 Lancaster Store Rd			
City	Castalia	County Wake	State NC	Zip Code 27816
Lender/Client	N/A			

TOTAL Sketch by a la mode, inc.

Area Calculations Summary

Living Area	Calculation Details		
First Floor	2796.66 Sq ft		$10.15 \times 3.85 = 39.08$ $14 \times 13.6 = 190.4$ $8.75 \times 8.1 = 70.88$ $18.1 \times 5.35 = 96.84$ $29.05 \times 7.3 = 212.06$ $61.4 \times 33.2 = 2038.48$ $1.35 \times 14.3 = 19.3$ $41.15 \times 3.15 = 129.62$
Second Floor	1635.3 Sq ft		$8.25 \times 6.45 = 53.21$ $14 \times 19.8 = 277.2$ $23.85 \times 18 = 429.3$ $12.45 \times 20.1 = 250.24$ $20.7 \times 18.7 = 387.09$ $12 \times 18.95 = 227.4$ $1.75 \times 6.2 = 10.85$
Total Living Area (Rounded):	4432 Sq ft		
Non-living Area			
3 Car Attached	1010.26 Sq ft		$11.65 \times 2 = 23.3$ $11 \times 8.75 = 96.25$ $24.85 \times 13.8 = 342.93$ $24.45 \times 19.1 = 467$ $15.1 \times 5.35 = 80.78$
Covered Porch	319.24 Sq ft		$8.2 \times 9.8 = 80.36$ $9.15 \times 5.55 = 50.78$ $31.35 \times 6 = 188.1$
Screened Porch	183.6 Sq ft		$13.5 \times 13.6 = 183.6$
Covered Deck	136 Sq ft		$13.6 \times 10 = 136$
Wood Deck	118 Sq ft		$10 \times 11.8 = 118$
Workshop/Storage	958.21 Sq ft		$34.1 \times 28.1 = 958.21$
Covered Overhang	341 Sq ft		$10 \times 34.1 = 341$
Covered Overhang	341 Sq ft		$34.1 \times 10 = 341$
Walk-in Storage	530.35 Sq ft		$18.1 \times 21.6 = 390.96$ $6.1 \times 22.85 = 139.38$