

Building Sketch (Page - 1)

Borrower	N/A			
Property Address	3209 Roxbury Dr			
City	Wake Forest	County Durham	State NC	Zip Code 27587
Lender/Client	N/A			

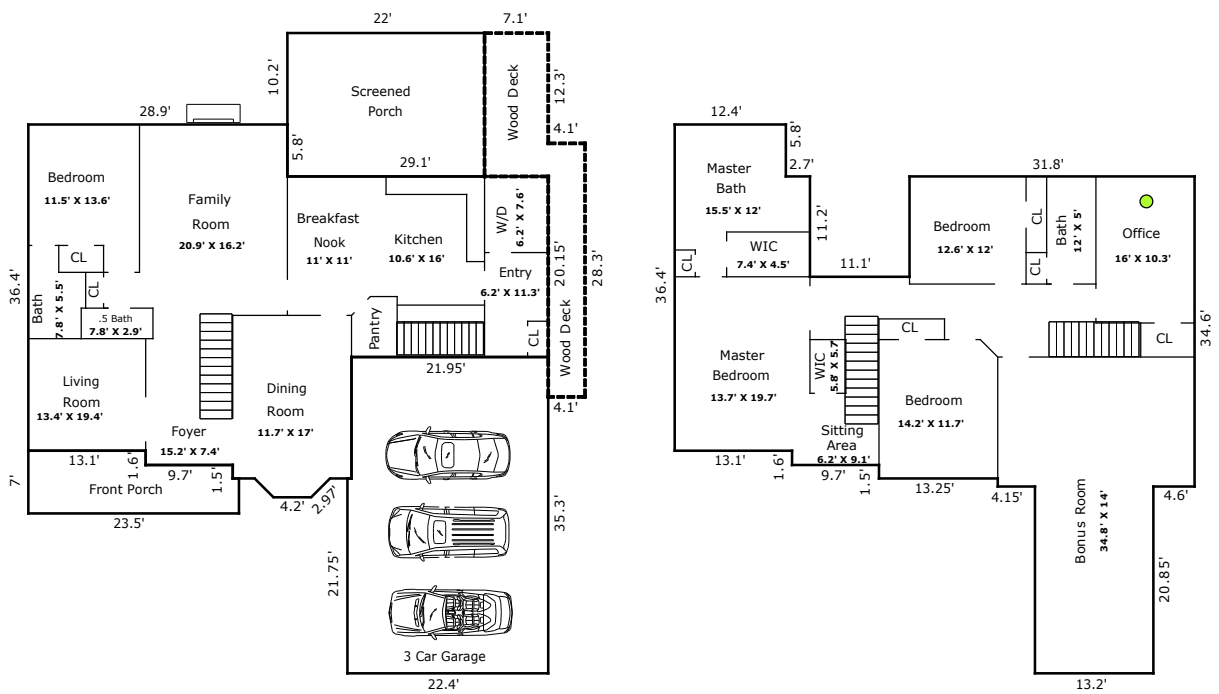

TOTAL Sketch by a la mode, inc.

Building Sketch (Page - 2)

Borrower	N/A			
Property Address	3209 Roxbury Dr			
City	Wake Forest	County Durham	State NC	Zip Code 27587
Lender/Client	N/A			

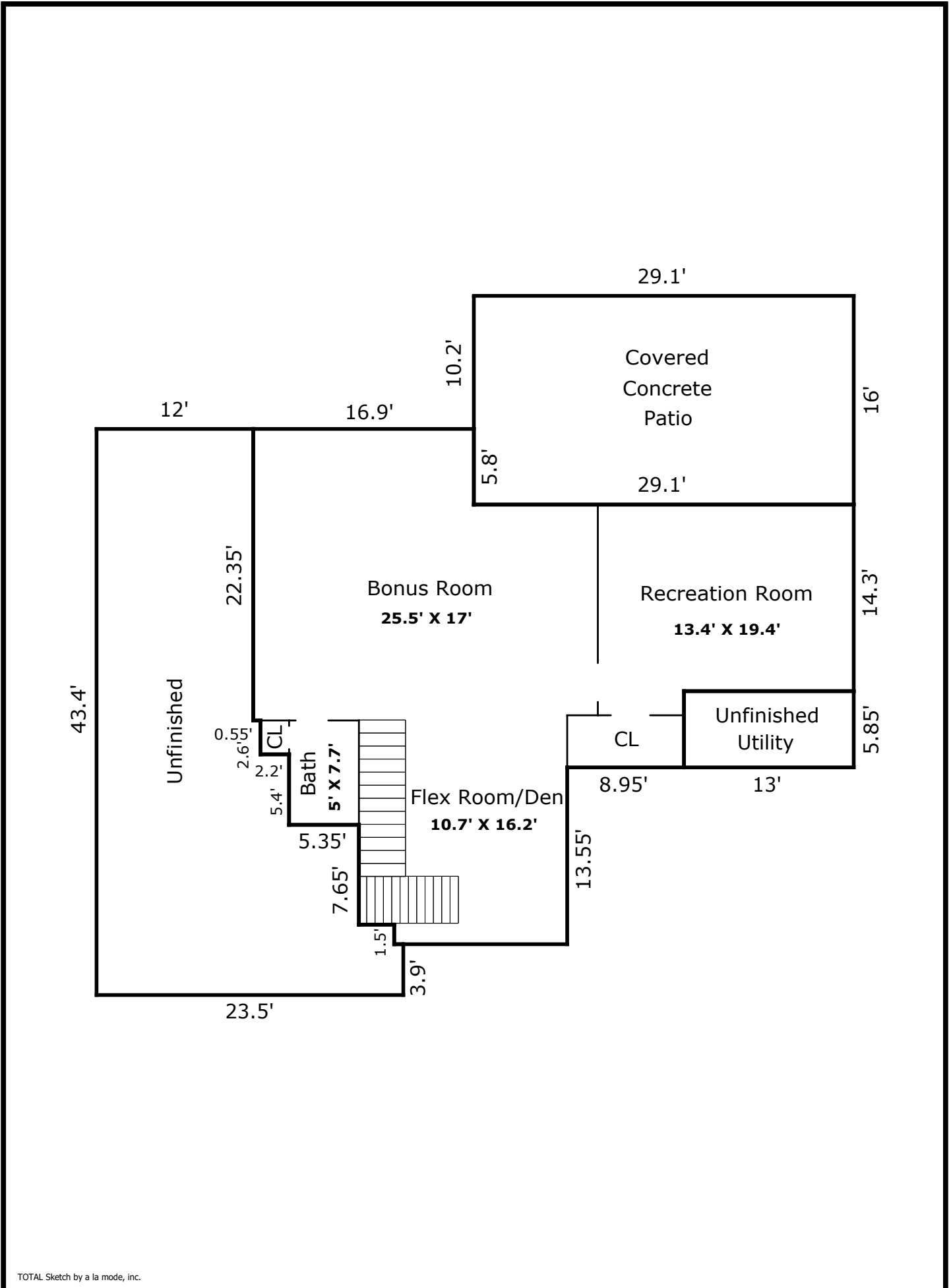

TOTAL Sketch by a la mode, inc.

Building Sketch (Page - 3)

Borrower	N/A			
Property Address	3209 Roxbury Dr			
City	Wake Forest	County Durham	State NC	Zip Code 27587
Lender/Client	N/A			

TOTAL Sketch by a la mode, inc.

Area Calculations Summary

Living Area	Calculation Details	
First Floor	1782.87 Sq ft	$0.5 \times 2.1 \times 2.1 = 2.2$ $0.5 \times 2.1 \times 2.1 = 2.2$ $4.2 \times 2.1 = 8.82$ $20.15 \times 21.95 = 442.29$ $36.4 \times 13.1 = 476.84$ $15.8 \times 5.8 = 91.64$ $22.95 \times 32.2 = 738.99$ $1.5 \times 13.25 = 19.88$
Second Floor	2142.01 Sq ft	$13.2 \times 20.85 = 275.22$ $34.6 \times 21.95 = 759.47$ $12.4 \times 5.8 = 71.92$ $15.1 \times 11.2 = 169.12$ $9.85 \times 11.2 = 110.32$ $19.4 \times 13.1 = 254.14$ $22.95 \times 21 = 481.95$ $13.25 \times 1.5 = 19.88$
Total Living Area (Rounded):	3925 Sq ft	
Non-living Area		
Screened Porch	352 Sq ft	$22 \times 16 = 352$
Wood Deck	229.63 Sq ft	$28.3 \times 4.1 = 116.03$ $7.1 \times 16 = 113.6$
Covered Porch	146.81 Sq ft	$7 \times 13.1 = 91.7$ $5.4 \times 9.7 = 52.38$ $0.7 \times 3.9 = 2.73$
3 Car Attached	784.62 Sq ft	$22.4 \times 21.75 = 487.2$ $21.95 \times 13.55 = 297.42$
Covered Patio	465.6 Sq ft	$29.1 \times 16 = 465.6$
Finished Basement	1180.3 Sq ft	$14.3 \times 13 = 185.9$ $20.15 \times 8.95 = 180.34$ $16.9 \times 5.8 = 98.02$ $24.05 \times 16.55 = 398.03$ $2.6 \times 2.2 = 5.72$ $17.15 \times 13.25 = 227.24$ $8.05 \times 8 = 64.4$ $2.7 \times 7.65 = 20.66$
Unfinished Basement	76.05 Sq ft	$13 \times 5.85 = 76.05$
Unfinished Basement	660.09 Sq ft	$12 \times 22.35 = 268.2$ $21.05 \times 12.55 = 264.18$ $2.2 \times 5.4 = 11.88$ $7.55 \times 7.65 = 57.76$ $5.4 \times 10.25 = 55.35$ $3.9 \times 0.7 = 2.73$