

Building Sketch (Page - 1)

Borrower	N/A			
Property Address	1328 Kinsdale Dr			
City	Raleigh	County Johnston	State NC	Zip Code 27615
Lender/Client	N/A			

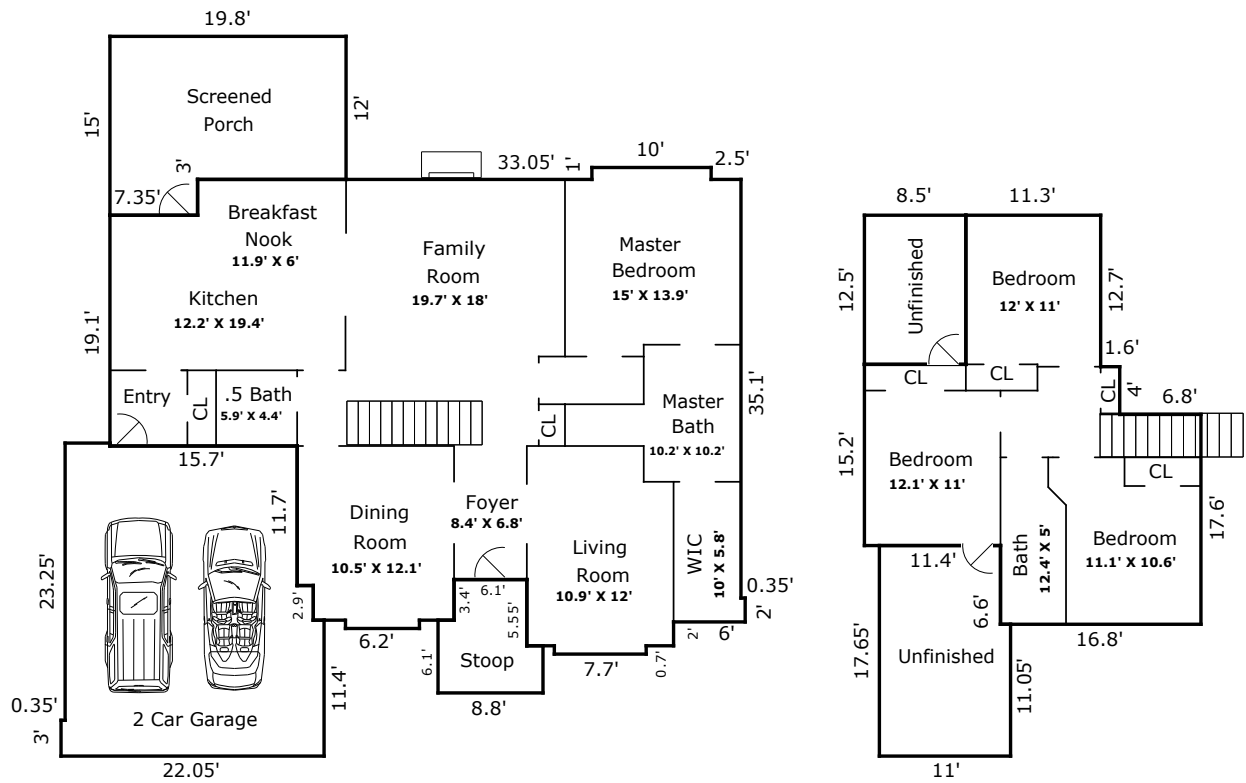

TOTAL Sketch by a la mode, inc.

Building Sketch (Page - 2)

Borrower	N/A			
Property Address	1328 Kinsdale Dr			
City	Raleigh	County Johnston	State NC	Zip Code 27615
Lender/Client	N/A			

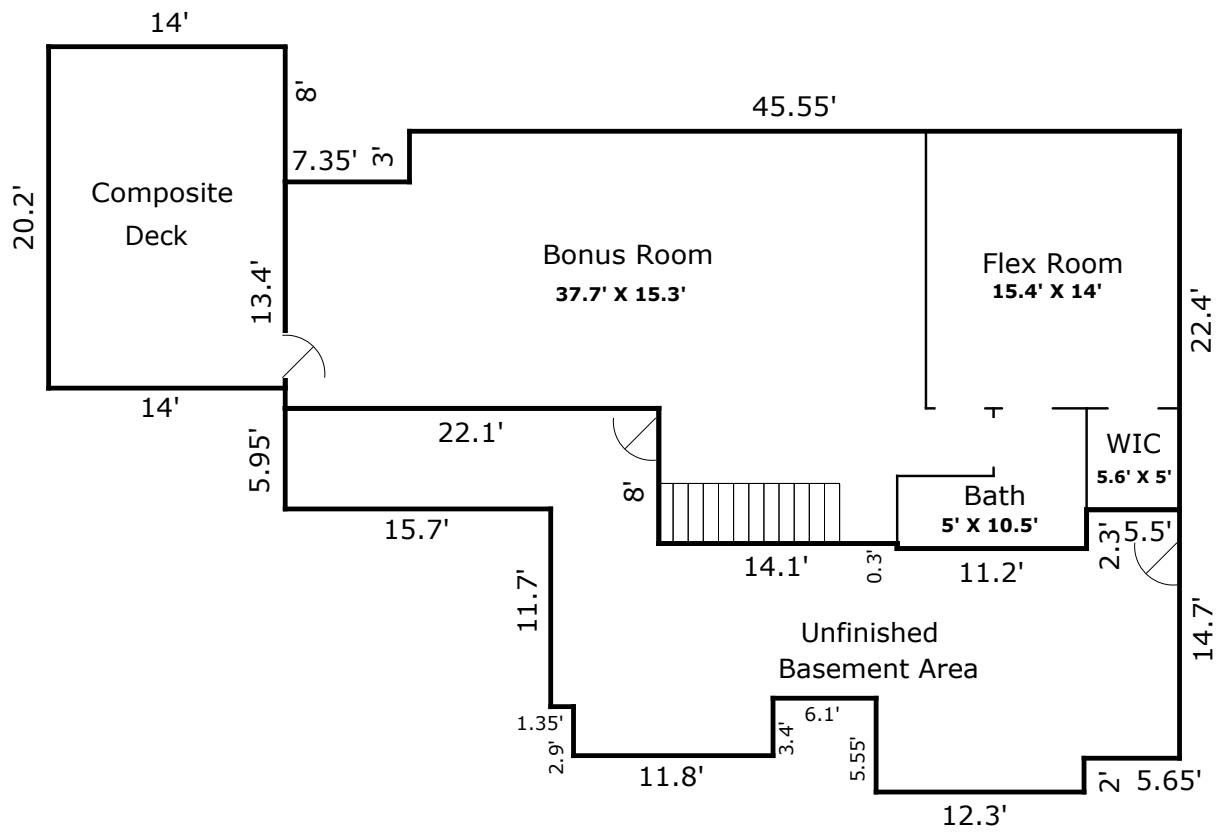

TOTAL Sketch by a la mode, inc.

Building Sketch (Page - 3)

Borrower	N/A			
Property Address	1328 Kinsdale Dr			
City	Raleigh	County Johnston	State NC	Zip Code 27615
Lender/Client	N/A			

TOTAL Sketch by a la mode, inc.

Area Calculations Summary

Living Area	Calculation Details		
First Floor	1726.45 Sq ft		
		$6.2 \times 0.7 =$	4.34
		$7.7 \times 0.7 =$	5.39
		$10 \times 1 =$	10
		$19.35 \times 7.35 =$	142.22
		$45.55 \times 22.35 =$	1018.04
		$37.2 \times 11.2 =$	416.64
		$5.55 \times 12.3 =$	68.26
		$3.55 \times 5.65 =$	20.06
		$2 \times 0.35 =$	0.7
		$0.5 \times 1.35 =$	0.68
		$11.8 \times 3.4 =$	40.12
Second Floor	651.89 Sq ft		
		$11.3 \times 12.5 =$	141.25
		$15.2 \times 11.4 =$	173.28
		$16.8 \times 17.6 =$	295.68
		$4.2 \times 8.4 =$	35.28
		$1.6 \times 4 =$	6.4
Total Living Area (Rounded):	2378 Sq ft		
Non-living Area			
Stoop	71.52 Sq ft		
		$6.1 \times 3.4 =$	20.74
		$6.1 \times 7.45 =$	45.44
		$1.35 \times 3.95 =$	5.33
Screened Porch	259.65 Sq ft		
		$12 \times 12.45 =$	149.4
		$7.35 \times 15 =$	110.25
2 Car Attached	537.25 Sq ft		
		$22.05 \times 3 =$	66.15
		$21.7 \times 8.4 =$	182.28
		$2.9 \times 1.35 =$	3.92
		$14.6 \times 15.7 =$	229.22
		$3.75 \times 14.85 =$	55.69
Walk-in Storage	188.54 Sq ft		
		$11 \times 11.05 =$	121.55
		$10.15 \times 6.6 =$	66.99
Walk-in Storage	106.25 Sq ft		
		$12.5 \times 8.5 =$	106.25
Trex Deck	282.8 Sq ft		
		$14 \times 20.2 =$	282.8
Unfinished Basement	621.75 Sq ft		
		$5.95 \times 15.7 =$	93.42
		$6.4 \times 8 =$	51.2
		$5.5 \times 2.3 =$	12.65
		$12.4 \times 5.65 =$	70.06
		$14.4 \times 11.05 =$	159.12
		$20.5 \times 9.15 =$	187.58
		$1.25 \times 5.55 =$	6.94
		$0.5 \times 1.35 =$	0.68
		$11.8 \times 3.4 =$	40.12
Finished Basement	1084.27 Sq ft		
		$13.4 \times 7.35 =$	98.49
		$16.4 \times 14.75 =$	241.9
		$30.8 \times 22.4 =$	689.92
		$2.3 \times 11.2 =$	25.76
		$2 \times 14.1 =$	28.2