

SKETCH ADDENDUM

Borrower or Owner				
Property Address 1532 LONG COVE COURT				
City	RALEIGH	County	WAKE	State NC
			Zip Code	27604
Client Ashley Pearce				

APPROXIMATE DIMENSIONS

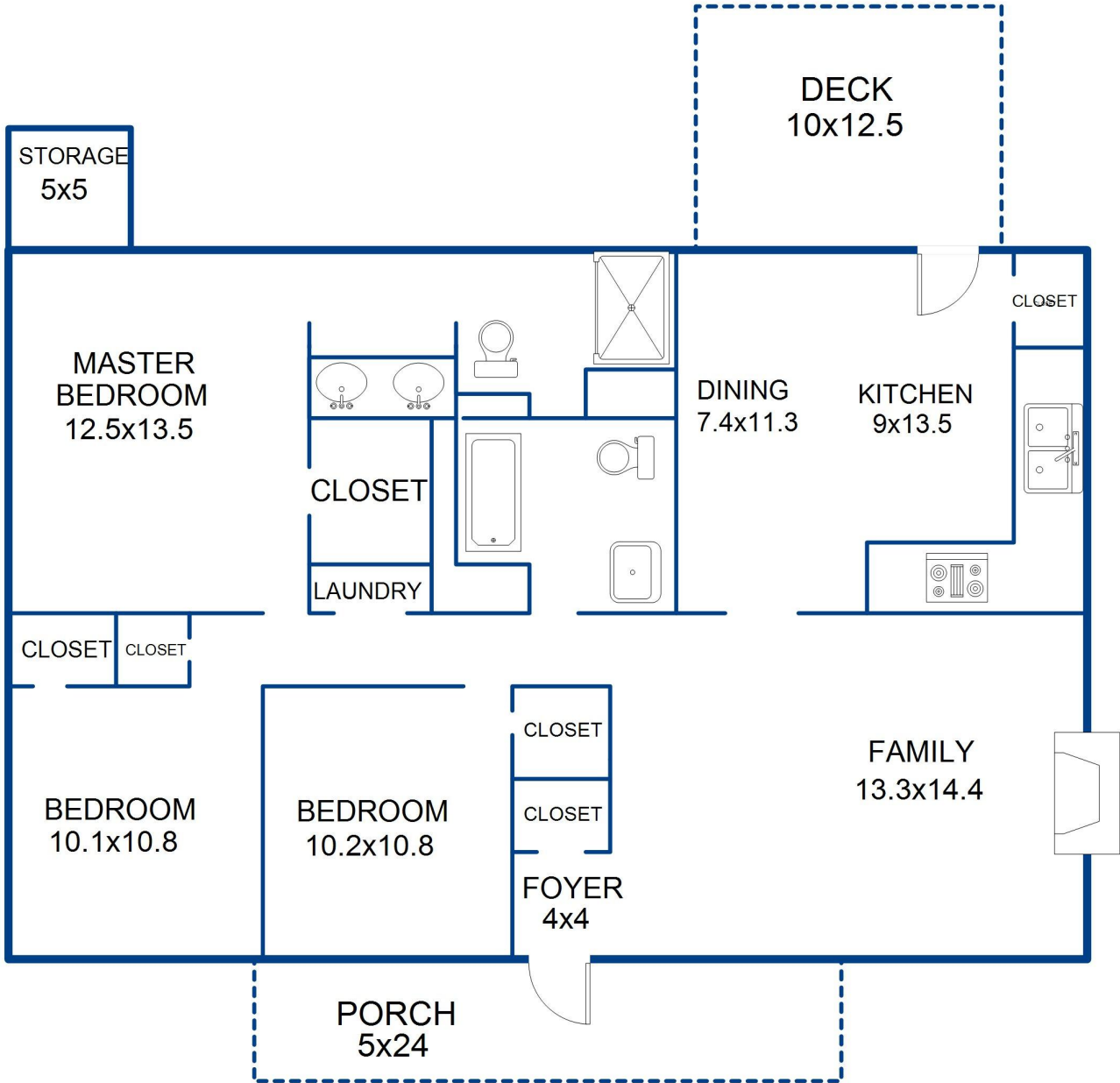

Sketch by Apex Sketch

AREA CALCULATIONS SUMMARY						AREA CALCULATIONS BREAKDOWN				
Code	Description	Factor	Net Size	Perimeter	Net Totals	Name	Base x	Height x	Width =	Area
GLA1	First Floor	1.0	1283.3	146.4	1283.3	First Floor		44.1 x	29.1 =	1283.3
OTH	Storage	1.0	25.0	20.0	25.0					
P/P	Wood Deck	1.0	125.0	45.0						
	Porch	1.0	120.0	58.0	245.0					
Net LIVABLE			(rounded)		1,283	1 total items			(rounded)	1,283