

SUBJECT PROPERTY IS        IS NOT X LOCATED IN A SPECIAL FLOOD HAZARD AREA AS DESIGNATED ON FEDERAL EMERGENCY MANAGEMENT AGENCY (F.E.M.A.) FLOOD INSURANCE RATE MAP NUMBER 3720176200J ZONE X

TRACT 2

SEE MAP ENTITLED EXEMPT SUBDIVISION FOR THOMAS WILLIAMSON BM 2008 PG. 2326

BM 2005 PG. 1828

S 01°30'55" E 130.14'

100' NEUSE RIVER BUFFER SCALED FROM 2005 PG. 1828

FLOOD HAZARD SOILS SCALED FROM 2005 PG. 1828

C/L CREEK (CREEK ±3' WIDE)  
20' PUBLIC DRAINAGE EASEMENT SCALED FROM BM 2005 PG. 1828

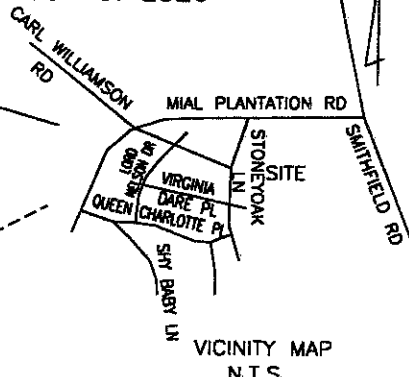

SETBACKS:  
FRONT= 30'  
SIDE= 10'  
REAR= 30'

IMPERVIOUS SURFACE 6,459 S.F. PER LOT SEE BM 2005 PG. 1828

LOT 10  
1.46 AC

TOTAL IMPERVIOUS AREA 5,850 SF EXCLUDING THE DECK

FLOOD HAZARD SOILS SCALED FROM 2005 PG. 1828

N 72°20'00" E 525.39'

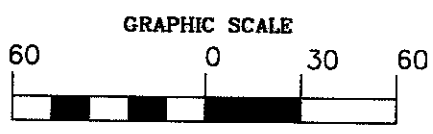
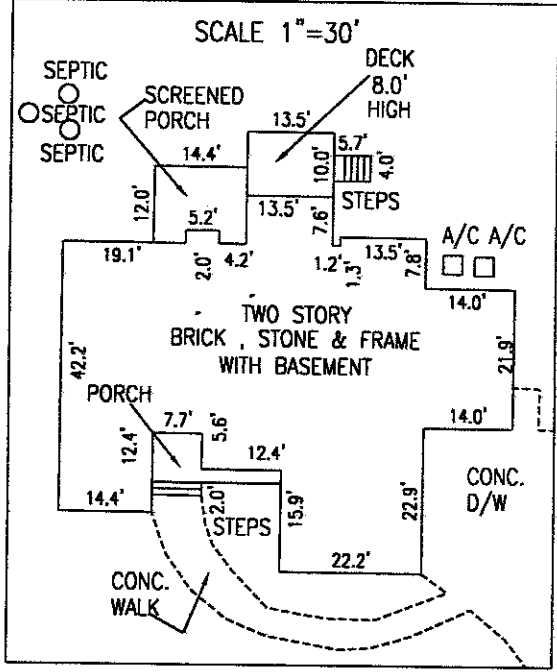

( IN FEET )  
1 inch = 60 ft.

699.03' TO A POINT WHERE STONEYOAK LANE BEGINS TO CURVE INTO VIRGINIA DARE PLACE BY BM 2005 PG. 1828

LOT 9

20' ACCESS EASEMENT SEE BM 2005 PG. 1828

S 72°20'00" W 489.19'

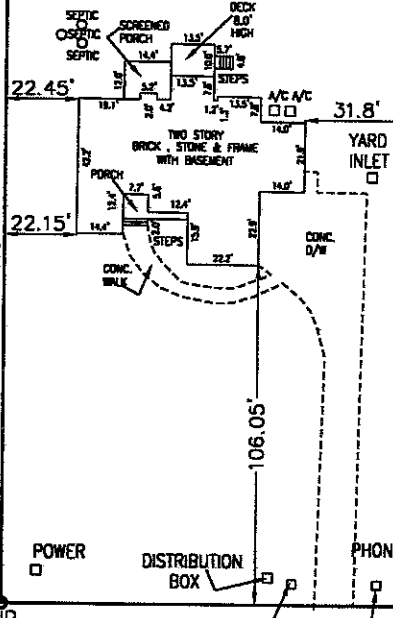

PIN # 1762108534

N 17°40'00" W 125.00'  
STONEYOAK LANE  
50' PUBLIC R/W

FIELD CLOSURE 1:14,360

STONEWATER SUBDIVISION  
LOT 10 BLOCK \_\_\_\_\_  
RECORDED IN BOOK OF MAPS 2005 VOL. \_\_\_\_\_ PAGE 1828 WAKE COUNTY, N.C.

LEGEND  
EIP EXISTING IRON PIPE MH MANHOLE  
NIP NEW IRON PIPE PP POWER POLE  
MON MONUMENT R/W RIGHT OF WAY  
PK PARKER KALON NAIL C/L CENTER LINE  
C.B. CATCH BASIN FES FLARED END SECTION  
NOT FOR RECORDING, INFORMATION FOUND

I, JOHN Y. PHELPS, JR. HEREBY CERTIFY THAT THIS MAP IS CORRECT AND THAT THE BUILDINGS LIE WHOLLY ON THE LOT AND THAT THERE ARE NO ENCROACHMENTS OF OTHER BUILDINGS ON SAID LOT UNLESS SHOWN OTHERWISE. THIS MAP IS NOT FOR RECORDING.

PROPERTY OF  
DONALD BUTLER &  
FAYE BUTLER  
4905 STONEYOAK LANE  
MARK'S TWSP., WAKE CO., N.C.

SCALE  
1"=60'  
DATE  
06/15/16  
1527  
85606

JOHN Y. PHELPS, JR.  
PROFESSIONAL LAND SURVEYOR  
5110 BUR OAK CIRCLE  
RALEIGH, NORTH CAROLINA, 27612 (919) 787-3658

